

PLANNED DEVELOPMENT  
 ORDINANCE NO.  
 PLANNING UNIT NO.

135  
3531  
Z831LS31

AN ORDINANCE AMENDING THE ZONING MAP SHOWING THE LOCATION, BOUNDARY AND USE OF CERTAIN PROPERTY SO AS TO REZONE PART OF THE S.F. MCCOMMAS SURVEY, ABSTRACT NO. 887, AND THE THOMAS J. TONE SURVEY, ABSTRACT NO. 1460, GENERALLY LOCATED 2000' SOUTH OF INTERSTATE HIGHWAY 20 AND WEST OF SOUTH BELTLINE ROAD, FROM THE (PD) PLANNED DEVELOPMENT ZONING DISTRICT TO: THE (PD) PLANNED DEVELOPMENT ZONING DISTRICT FOR COMMERCIAL, OFFICE, AND MULTI-FAMILY RESIDENTIAL USES. SAID ZONING MAP AND ORDINANCE PASSED ON JANUARY 27, 1971 AND RECORDED IN BOOK 8, PAGES 405 TO 509 OF THE ORDINANCE RECORDS OF THE CITY OF GRAND PRAIRIE, TEXAS; REPEALING ALL ORDINANCES OR PARTS OF ORDINANCES IN CONFLICT HEREWITH: CONTAINING A SAVINGS CLAUSE AND TO BECOME EFFECTIVE UPON ITS PASSAGE AND APPROVAL.

WHEREAS, the owners of the hereinafter described property filed application with the City of Grand Prairie, Texas, petitioning an Amendment of the Zoning Ordinance and Map of said City so as to rezone and reclassify said property from its classification of (PD) Planned Development to (PD) Planned Development No. 135; and

WHEREAS, the Zoning Commission of Grand Prairie, Texas, held a public hearing on said application on October 24, 1983 after written Notice of such public hearing before the Zoning Commission on the proposed change in classification had been sent to owners of real property lying within 200 feet of the property on which the change in classification is proposed, said Notice having been given not less than ten (10) days before the date set for hearing to all such owners who rendered their said property for City taxes as the ownership appears on the last approved City Tax Roll, and such Notice being served by depositing the same, properly addressed and postage paid, in the City Post Office; and

WHEREAS, after consideration of said application, the Zoning Commission of the City of Grand Prairie, Texas voted 4 to 2 to recommend to the City Council of Grand Prairie, Texas, that the hereinafter described property be rezoned so as to change its classification from (PD) Planned Development to (PD) Planned Development No. 135; and

WHEREAS, subsequent to the public hearing of the Zoning Commission, Notice was given of a further public hearing to be held by the City Council of the City of Grand Prairie, Texas, in the Municipal Building at 7:00 o'clock p.m. on November 1, 1983 to consider the advisability of amending the Zoning Ordinance and Map as recommended by the Zoning Commission, and all citizens and parties at interest were notified that they would have an opportunity to be heard, such Notice of the time and place of such hearing having been given at least fifteen (15) days prior to such hearing by publication in the Grand Prairie Daily News, Grand Prairie, Texas, a newspaper of general circulation in such municipality; and

WHEREAS, all citizens and parties at interest have been given an opportunity to be heard on the matter of the proposed rezoning; and the City Council of the City of Grand Prairie, Texas, being informed as to the location and nature of the property sought to be rezoned, as well as the nature and utilization of surrounding property, have found and determined that the property in question, as well as other property within the City Limits of the City of Grand Prairie, Texas, has changed in character since the enactment of the original Zoning Ordinance from the classification of (PD) Planned Development by reason of changed conditions, does consider and find that this amendatory Ordinance should be enacted since its provisions are in the public interest and will promote the health, safety and welfare of the community.

NOW, THEREFORE, BE IT ORDAINED BY THE CITY COUNCIL OF THE CITY OF GRAND PRAIRIE, TEXAS:

I.

That the Zoning Ordinance and Map of the City of Grand Prairie, Texas, showing the locations and boundaries of certain districts, and said Zoning Ordinance and Map having been made a part of an Ordinance entitled:

"AN ORDINANCE AMENDING IN ITS ENTIRETY CHAPTER 36 OF THE CODE OF ORDINANCES KNOWN AS THE ZONING ORDINANCE OF THE CITY OF GRAND PRAIRIE, TEXAS, AS PASSED AND APPROVED BY THE CITY COUNCIL ON THE 27th DAY OF JANUARY, 1971, TOGETHER WITH ALL AMENDMENTS THERETO AND ENACTING A REVISED ORDINANCE ESTABLISHING AND PROVIDING FOR ZONING REGULATIONS; CREATING USE DISTRICTS IN ACCORDANCE WITH A COMPREHENSIVE PLAN . . . ."

and passed and approved January 27, 1971, recorded in Ordinance Book 8, Pages 405 to 509 inclusive, as amended, so as to establish and rezone the following described area from (PD)Planned Development to (PD) Planned Development for Commercial, Office, and Multi-Family Residential uses.

II.  
COMMERCIAL

1. PERMITTED USES:

In areas designated for commercial uses, pursuant to Exhibit "A", attached hereto, no land shall be used and no building shall be erected or converted to any use other than:

A. PRIMARY RESIDENTIAL USES:

Hotel or motel.

B. EDUCATIONAL, INSTITUTIONAL AND SPECIAL USES:

Church or Rectory, College or University, Private Primary or Secondary School, Day Nursery or Kindergarten School, Farm, Ranch, Garden or Orchard, Fishing Pier and Bait Sales, Fraternal Organization, Lodge or Civic Club, Golf Course, Private or Country Club, Hospital (General Acute Care), Hospital (Chronic Care), Institutions of Religious or Philanthropic Nature, Park, Playground or Public Community Center, Residence Home for Aged, School, (Public or Parochial), Tennis or Swim Club.

C. UTILITY, ACCESSORY AND INCIDENTAL USES:

Accessory Building, Electrical Substation, Electrical Transmission Line, Field or Construction Office (Temporary), Gas Transmission Line and Metering Station, Home Occupation, Local Utility Distribution Lines, Off-Street Parking Incidental to Main Use, Private Club, Public or Private Utility Co., Railroad Track and Right-of-Way, Swimming Pool (Private), Telephone Exchange, Water Reservoir, Water Pumping Station and Well.

D. SIGN AND IDENTIFICATION USES:

Temporary Signs, Portable Signs, Electric Signs, Commercial Signs, Official Signs, all subject to the requirements as prescribed in Section E-300 of the Comprehensive Zoning Ordinance of the City of Grand Prairie.

E. RETAIL AND SERVICE TYPE USES:

Antique Shop, Bakery or Confectionery Shop (Retail), Cleaning and Pressing, Custom Personal Service Shop, Discount Variety or Department Store, Drapery, Needlework or Weaving Shop, Florist or Garden Shop, Greenhouse or Plant Nursery (Retail), Handcraft Shop, Household Appliance Service and Repair, Laundry or Cleaning, Self-Service, Mimeograph, Stationery or Letter Shop, Mortuary or Funeral Parlor, Furniture or Appliance Store, Offices (Professional and Administrative), Pawn Shop, Pet Shop, Restaurant or Cafeteria Without Drive-in Service, Restaurant with Drive-in Service, Retail Stores and Shops other than listed, Studio for Photographer, Musician or Artist, Theater (Indoor).

F. AUTOMOBILE AND RELATED SERVICE USES:

Gasoline Service Station, Car-Wash or Car Care Center, New Auto Part Sales Store.

G. COMMERCIAL TYPE USES:

Commercial Amusements (Indoors), Scientific or Research Laboratories, (Storage or Warehouse Non-Commercial), Trade or Commercial School, Veterinarian Office Only, (No Outside Pens), Wholesale Office and Sample Room.

H. OTHER USES ALLOWED:

All other uses as allowed in the (C) Commercial District of the Comprehensive Zoning Ordinance of the City of Grand Prairie.

2. AREA REQUIREMENTS:

- A. Minimum depth of front setback..... 25 feet  
(From front property line to face of structure)
  
- B. Minimum width of side setback:  
(Distance between structure and any property  
line that is not deemed a front or rear yard)
  - 1. Internal lot..... 0 feet
  - 2. Sideyard setback abutting a street..... 15 feet
  - 3. Sideyard abutting residentially zoned or used property..... 25 feet
  
- C. Minimum depth of rear setback: ..... 0 feet  
(From rear property line to any structure)
  - 1. Rear yard abutting residentially zoned or used property ..... 25 feet
  
- D. Maximum height of structures.....20 stories
  
- E. Off-Street Parking:  
Off-street loading and parking space shall be provided in accordance with  
applicable sections in the (C) Commercial District of the Comprehensive  
Zoning Ordinance of the City of Grand Prairie.

3. SPECIAL FRONT, SIDE AND REAR YARD REGULATION-NO BUILDING OR  
STRUCTURE SHALL HEREAFTER BE LOCATED, ERECTED OR ALTERED TO  
HAVE A REAR OR SIDE YARD SMALLER THAN HEREINAFTER REQUIRED.

- A. Every part of a required side or rear yard shall be open and unobstructed  
to the sky from a point thirty (30) inches above the general ground level  
of the graded lot, except for accessory buildings as permitted in Section  
E-200 of the Grand Prairie Zoning Ordinance and the usual landscape  
planting and lighting. The ordinary projections of window sills, belt  
courses, cornices, roof overhangs, and other architectural features  
may project not more than four (4) feet into the required yard  
yard.
  
- B. Gasoline service station pump islands may not be located nearer than 20  
feet to the front property line. The outer edge of the canopy shall not  
be nearer than 10 feet to the front property line.

4. SCREENING REQUIREMENTS:

Non-residential uses shall be screened from residentially zoned or used land in  
accordance with Section E-400 of the Comprehensive Zoning Ordinance of the  
City of Grand Prairie.

III.  
OFFICE

1. PERMITTED USES:

In areas designated for office uses, pursuant to Exhibit "A", attached hereto, no land shall be used and no building shall be erected or converted to any use other than:

A. PRIMARY RESIDENTIAL USES:

Hotel or motel.

B. EDUCATIONAL, INSTITUTIONAL AND SPECIAL USES:

Cemetery or Mausoleum, Church and Rectory, College or University, Private Primary or Secondary School, Day Nursery or Kindergarten School, Farm, Ranch, Garden or Orchard, Fishing Pier and Bait Sales, Fraternal Organization, Lodge or Civic Club, Golf Course, Private or Country Club, Hospital (General Acute Care), Hospital (Chronic Care), Institutions of Religious or Philanthropic Nature, Monastery or Convent, Park, Playground or Public Community Center, Residence Home for Aged, School, (Public or Parochial), Tennis or Swim Club.

C. UTILITY, ACCESSORY AND INCIDENTAL USES:

Accessory Building, Electrical Substation, Electrical Transmission Line, Field or Construction Office (Temporary), Gas Transmission Line and Metering Station, Home Occupation, Local Utility Distribution Lines, Off-Street Parking Incidental to Main Use, Private Club, Public or Private Utility Co. Shop or Storage, Railroad Track and Right-of-Way, Swimming Pool (Private), Telephone Exchange, Water Reservoir, Water Pumping Station and Well.

D. SIGN AND IDENTIFICATION USES:

Temporary Signs, Portable Signs, Electric Signs, Commercial Signs, Official Signs, all subject to the requirements as prescribed in Section E-300 of the Comprehensive Zoning Ordinance of the City of Grand Prairie.

E. RETAIL AND SERVICE TYPE USES:

Antique Shop, Bakery or Confectionery Shop (Retail), Cleaning and Pressing, Custom Personal Service Shop, Discount Variety or Department Store, Drapery, Needlework or Weaving Shop, Florist or Garden Shop, Greenhouse or Plant Nursery (Retail), Handcraft Shop, Household Appliance Service and Repair, Laundry or Cleaning, Self-Service, Mimeograph, Stationery or Letter Shop, Mortuary or Funeral Parlor, Furniture or Appliance Store, Offices, Professional and Administrative, Pawn Shop, Pet Shop, Restaurant or Cafeteria Without Drive-In Service, Restaurant with Drive-In Service, Retail Stores and Shops other than listed, Studio for Photographer, Musician or Artist, Theater (Indoor).

F. AUTOMOBILE AND RELATED SERVICE USES:

Gasoline Service Station, Car-Wash or Car Care Center, New Auto Part Sales Store.

G. COMMERCIAL TYPE USES:

Commercial Amusements (Indoors), Scientific or Research Laboratories, (Storage or Warehouse Non-Commercial), Trade or Commercial School, Veterinarian Office Only, (No Outside Pens), Wholesale Office and Sample Room.

H. OTHER USES ALLOWED:

All other uses as allowed in the (C) Commercial District of the Comprehensive Zoning Ordinance of the City of Grand Prairie.

2. AREA REQUIREMENTS:

- A. Minimum Depth of Front Setback..... 25 feet  
(From front property line to face of structure)
  
- B. Minimum Width of Side Setback:  
(Distance between structure and any property  
line that is not deemed a front or rear yard.)
  - 1. Internal lot ..... 0 feet
  - 2. Sideyard setback abutting a street ..... 15 feet
  - 3. Sideyard abutting residentially zoned or used property ..... 25 feet
  
- C. Minimum depth of rear setback:..... 0 feet  
(From rear property line to any structure)
  - 1. Rear yard abutting residentially zoned or used property..... 25 feet
  
- D. Maximum height of structures: ..... 20 stories
  
- E. Off-Street Parking:  
Off-street loading and parking space shall be provided in accordance with  
applicable sections in the (O) Office District of the Comprehensive  
Zoning Ordinance of the City of Grand Prairie.

3. SPECIAL SIDE AND REAR YARD REGULATIONS-NO BUILDING OR  
STRUCTURE SHALL HEREAFTER BE LOCATED, ERECTED OR ALTERED TO  
HAVE A REAR OR SIDE YARD SMALLER THAN HEREINAFTER REQUIRED.

Every part of a required side or rear yard shall be open and unobstructed to the sky from a point thirty (30) inches above the general ground level of the graded lot, except for accessory buildings as permitted in Section E-200 of the Grand Prairie Zoning Ordinance and the usual landscape planting and lighting. The ordinary projections of window sills, belt courses, cornices, roof overhangs, and other architectural features may project not more than four (4) feet into the required yard.

4. SCREENING REQUIREMENTS:

Non-residential uses shall be screened from residentially zoned or used land is accordance with Section E-400 of the Comprehensive Zoning Ordinance ofa the City of Grand Prairie.

IV.  
MULTI-FAMILY/CONDOMINIUM RESIDENTIAL

1. PERMITTED PRINCIPAL USES:

In areas designated for multi-family residential uses, no land shall be used and no building shall be erected or converted to any use other than:

- A. All uses as provided in Section B-100 of the Comprehensive Zoning Ordinance of the City of Grand Prairie for the (MF-1) Multi-Family District, except single-family detached residential structures, which are specifically precluded from this district.
- B. Temporary real estate sales offices located on property being sold, or on-site construction offices limited to the period of sale or construction of 100% of the lots, whichever may be the later date.
- C. Paved automobile parking areas which are necessary to the uses permitted in this district.
- D. Customary home occupations as defined in Section B-800 of the Comprehensive Zoning Ordinance of the City of Grand Prairie.
- E. Municipally owned or controlled facilities, utilities, and uses, except those uses that may require a Specific Use Permit.
- F. Townhouses, which shall meet the requirements of the SF-TH District of the Comprehensive Zoning Ordinance of the City of Grand Prairie. Only one townhouse dwelling unit shall be allowed per lot of record.
- G. Duplexes, which shall meet the requirements of the 2F District of the Comprehensive Zoning Ordinance of the City of Grand Prairie.
- H. Residential condominiums.
- I. Apartments.

2. PERMITTED ACCESSORY USES:

The following uses shall be permitted as accessory uses:

- A. Portable storage buildings not larger than one hundred twenty (120) square feet and ten (10) feet in height accessory to a principal residential use on the same lot.
- B. Private nurseries, greenhouses, swimming pools, spas or saunas, and gardens as an accessory use incidental to the principal residential use on the same lot.
- C. Complex office; meeting, party and/or social rooms incidental to the principal residential use on the same lot.
- D. Maintenance facility that serves only a principal use on the same lot.
- E. Satellite receiving dish, incidental to a principal residential use on the same lot, not to exceed twenty (20) feet in height.

3. PROHIBITED USES:

The following uses shall be prohibited in this District:

- A. Any building erected or land used for other than one or more of the preceding specified uses.
- B. The storage of equipment, material or vehicles, including abandoned vehicles, which are not necessary to the uses permitted in this district.
- C. A driveway or crosswalk way, as distinct from a dedicated street, to provide access to premises in a Commercial or Industrial District.
- D. Any use of property that does not meet the required minimum lot size, front, side and rear yard dimension, and/or lot width; or exceeds the maximum height, or building coverage as required.

4. AREA REQUIREMENTS:

- A. Minimum Lot Area .....12,000 sq. ft.
- B. Minimum lot area per dwelling unit.....2,420 sq. ft.

B. Minimum Required Floor Area:

Efficiency Unit	420 square feet
One Bedroom Unit	600 square feet
Two Bedroom Unit	800 square feet
Three Bedroom Unit	1000 square feet
Minimum Average Dwelling Unit Size	700 square feet

(Minimum required floor area as herein specified shall be computed exclusive of breezeways, garages, open porches, carports, accessory buildings or accessory space and designed and used directly and specifically for dwelling purposes.)

C. Minimum Lot Frontage on a Public Street..... 100 feet  
(Measured at the front building line)

D. Minimum lot depth..... 120 feet

E. Minimum depth of front setback..... 25 feet  
(From front property line to face of structure)

F. Minimum depth of rear setback of all structures ..... 10 feet  
(Including accessory structures)  
(From rear property line to any structure)  
(Unenclosed carports may be built up to within 5 feet of any property line that abuts an alley.)

G. Minimum width of side setback:  
(The distance between structure and any property line that is not deemed a front or rear yard.)

1. Internal lot ..... 10%  
of lot width with a maximum requirement of 10 feet for a one story structure or 15 feet for structures two or more stories in height.
2. Sideyard setback abutting a street..... 15 feet
3. Abutting an arterial..... 20 feet

H. Minimum distance from the public right-of-way to the entrance to a garage or unenclosed carport, for rear or side yards..... 18 feet  
Parking from an apartment complex shall not be allowed to take access directly from a public street or right-of-way. All maneuvering for off-street parking shall be accomplished on private property.)

I. Minimum required exterior masonry content:

All multi-family structures shall be of an exterior construction having at least eighty percent (80%) of the total exterior walls on the first and second floors, excluding doors and windows, constructed of standard size full-width brick or stone.

J. Height and Area Regulations:

1. Maximum allowable lot coverage..... 40 per cent  
(10% of the required 60% not covered by buildings shall be set aside for playground and leisure activities.)
2. Minimum amount of permanent, landscaped open space:  
20% of total lot area, including 30% of the frontyard as defined.
3. Maximum height of structures..... 3 stories



K. Maximum density per net acre .....18 units/acre

(Net acre shall be defined as the acreage of a tract of land less any existing or proposed rights-of-way of flood plain that is not either reclaimed or substantially improved as open space and incorporated into a project. The Planning and Zoning Commission shall make a determination, at the time of site plan approval, of the degree of improvement necessary to include flood plain in the acreage calculation.)

L. Minimum distance between buildings on the same lot or parcel of land:

- 1. 10 feet from main to accessory buildings.
- 2. 20 feet for 2 main buildings with doors and windows in facing walls.
- 3. 10 feet for 2 main buildings without doors and windows facing walls.

5. PARKING:

Minimum number of paved, striped, off-street parking spaces required for:

- I. 0 bedroom or efficiency dwelling unit ..... 1.25 spaces per unit
- 1 bedroom dwelling units ..... 2 spaces per unit
- 2 bedroom dwelling units ..... 2 spaces per unit
- 3 or more bedroom dwelling units ..... 2 spaces per unit

B. All other uses: As provided by applicable sections of the Comprehensive Zoning Ordinance of the City of Grand Prairie.

C. All off-street parking lots shall be constructed of four inch reinforced concrete, with six inch reinforced concrete located in areas where heavy truck traffic is expected. Every effort shall be made to prevent parking adjacent to major thoroughfares in the project area.

D. Parking areas and street frontages of multi-family development shall be landscaped with natural vegetation and maintained in a neat and orderly manner. Such landscaping shall be required to screen parking areas from the street frontage.

6. SIDEWALKS:

Sidewalks shall be constructed at least four (4) feet wide, four inches thick on a 6"x6" welded wire mesh, and meeting City standards along every public thoroughfare upon which the project has frontage.

7. SPECIAL RESIDENTIAL REGULATIONS:

A. SPECIAL FRONT YARD REGULATIONS - NO BUILDING OR STRUCTURE SHALL HEREAFTER BE LOCATED, ERECTED, OR ALTERED TO HAVE A FRONT YARD SMALLER THAN HEREINAFTER REQUIRED.

(a) The front setback shall be measured from the property line to the front face of the building, covered porch, covered terrace, or attached accessory building. Eaves and roof extensions may project into the required front yard for a distance not to exceed twenty-four (24) inches. (See Section G-100, Illustration 5, Grand Prairie Zoning Ordinance.)

- (b) On a lot abutting on two (2) non-intersecting streets as distinguished from a corner lot, a required front yard shall be provided on both streets, unless a building line for accessory buildings has been established along one frontage on the plat or by ordinance, in which event only one required front yard need be observed.

**B. SPECIAL SIDE AND REAR YARD REGULATIONS - NO BUILDING OR STRUCTURE SHALL HEREAFTER BE LOCATED, ERECTED OR ALTERED TO HAVE A REAR YARD SMALLER THAN HEREINAFTER REQUIRED.**

Every part of a required side or rear yard shall be open and unobstructed to the sky from a point thirty (30) inches above the general ground level of the graded lot, except for accessory buildings as permitted in Section E-200 of the Grand Prairie Zoning Ordinance and the usual landscape planting and lighting. The ordinary projections of window sills, belt courses, cornices, roof overhangs, and other architectural features may project twenty-four (24) inches into the required yard.

**C. SPECIAL OFF-STREET PARKING REGULATIONS:**

1. Recreational vehicles, which shall mean, for the purposes of this section, a vehicular portable structure, designed for a temporary or short-term occupancy for travel, recreational or vacation uses, are prohibited from parking on a public thoroughfare. Any vehicle, including recreational vehicles, over eight (8) feet wide and over thirty-six (36) feet long shall not be stored or parked in this district.
2. Any commercial vehicle over 8 feet wide and 20 feet long, may not be parked or stored in this residential area, unless such vehicle is delivering goods or services in the conduct of business to a specific residence.
3. This section shall not apply to parking, standing and/or storage of vehicles on public property in residential areas, which has specific restrictions defined in Chapter No. 25 of the Traffic Code of Ordinances.
4. Floor area of structure devoted to off-street parking of vehicles shall be excluded in computing the off-street parking requirements of any use. "Offstreet Parking" shall be defined as an unenclosed or enclosed concrete surface area of not less than 180 sq. ft. (approximately 9' X 20'), not on a public street or alley but permissible within a setback, together with an all-weather surface driveway connecting the area with a street or alley permitting free ingress-egress without encroachment on the street or alley.

**D. SPECIAL HEIGHT REGULATIONS:**

Cooling towers, roof gables, chimneys and vent stacks may extend for an additional height not to exceed forty (40) feet above the average grade line of the building. Water stand pipes and tanks, church steeples, domes and spires and school buildings and institutional buildings, may be erected to exceed three (3) stories in height, provided that one (1) additional foot shall be added to the width and depth of front, side and rear yards for each foot that such structures exceed three (3) stories.

**E. ADDITIONAL DEVELOPMENT REQUIREMENTS:**

To insure a higher standard of living for the occupant, each multi-family dwelling unit shall contain dishwasher, disposal, range with vent, and oven facilities. On-site common laundry facilities shall be provided within the development unless all units are provided with washer/dryer connections. Washer/dryer connections shall be provided in all two-bedroom units and larger.

8. SCREENING REGULATIONS:

Any premises developed for multi-family residential uses shall be buffered from abutting land developed into non-residential uses or residential uses having a lower net development density by a solid masonry wall, wooden fence, or other man-made or natural barrier or combination thereof built to the following minimum criteria:

1. **Walls & Fences:**  
A solid, non-transparent fence with a minimum of seven (7) feet from the ground level at or on the boundary lines or areas common to the premises and the area zoned for residential purposes, having concrete beams installed under the entirety of the fence to a minimum height of six (6) inches above ground and six (6) inches wide, placed on proper footing, either spread or piers, reinforced with a minimum of two (2) number three bars of steel. All posts shall be steel and all material shall be decay resistant.
2. **Earthen Berms:**  
Landscaped earthen berms shall be constructed to a minimum height of six (6) feet. Side slopes of such berms shall have a minimum of two (2) feet of horizontal distance for each one (1) foot of height. All berms shall contain necessary drainage provisions as may be required by the City Engineer.
3. Whenever a lot or tract of land is used for off-street parking of motor vehicles in connection with an office, church or similar institution, retail, commercial or industrial use and is adjacent to, or across the street from, a residentially zoned district, a masonry wall or solid ornamental fence of not less than three (3) feet nor more than six (6) feet in height shall be erected and maintained so as to enclose the off-street parking area and to screen the parking use from adjacent residential districts.
4. **Maintenance:**  
The area in front of the required screening wall or fence, shall be maintained in a clean, and orderly condition, free of weeds, debris, and trash.
5. **Lighting:**  
Any light used to illuminate the parking area shall be so arranged as to reflect away from any adjacent residential uses or residential districts.

V.  
SPECIAL CONDITIONS  
(APPLICABLE TO ALL AFOREMENTIONED DISTRICTS)

1. SIDEWALKS:

1. Sidewalks shall be provided:
  - (a) On both sides of Carrier Parkway;
  - (b) On one side of Bardin/Vineyard Road.

(All sidewalks shall, at a minimum, be four (4) feet wide, constructed of four (4) inches of concrete on a 6"x6" welded wire mesh)

2. UTILITIES:

All utilities servicing this development (other than perimeter utilities) shall be installed underground, except for any major transmission lines, either existing or proposed, located within the boundaries of this development.

3. GENERAL REQUIREMENTS AND STIPULATIONS:

- A. All proposed uses are subject to the approval of a development plan or preliminary plat by the City Council after recommendation by the Planning and Zoning Commission and prior to the issuance of a building permit or occupancy permit on the premises. Site plans and preliminary plats are to be prepared in accordance with existing City Policy. When a variety of land uses are proposed on a single tract of land, the site plan shall delineate the area proposed for each use.
- B. No use shall be located or operated in any district which involves the emission of odorous material, smoke or particulate matter or noise.
- C. The site or development plan finally adopted by the City Council shall be marked Exhibit "A", attached hereto and made a part hereof as if fully set out herein.

4. USE MATRIX:

The use matrix, attached hereto as Exhibit "B", shall be deemed to be a part of this ordinance.

VI.  
CITY PARTICIPATION

(a) Streets:

- (1) The City of Grand Prairie will participate in the cost of any street installations (including all engineering costs covering design, layout and construction supervision) up to fifty (50%) percent of the total cost for any street installed adjacent to a flood plain or other areas which the City has accepted or will later accept dedication as a park.

- (2) Standard street width (including curbs and gutters) for all streets to be installed shall be twenty-seven feet (27'), except for those streets indicated on Exhibit "A", attached hereto, and streets serving commercial, multi-family or garden home areas. Standard street width (including curbs and gutters) for all streets to be installed in garden home areas shall be thirty-one feet (31'), except that where an alley of a minimum width of ten feet (10') is provided to access garden homes, the standard street width (including curbs and gutters) shall be twenty-seven feet (27').
- (3) The standard street thickness required of the developer for Carrier Parkway (Corn Valley Road) and Camp Wisdom Road, and all streets in excess of forty-one (41) feet in width, shall be seven inches (7').
- (4) All other streets shall have a standard thickness of five inches (5"), and shall otherwise comply with the City of Grand Prairie's standards for residential streets.
- (5) The developer shall be responsible for a standard street width (including curbs and gutters) of forty-five (45) feet in the installation of Carrier Parkway (Corn Valley Road) for that portion of the development with commercial and/or multi-family development frontage on both sides of the thoroughfare, and shall be responsible for installation of one-half of a standard street width (including curbs and gutters) of forty-five (45) feet for that portion of the development with single-family development frontage on one or both sides of the thoroughfare.
- (6) The City of Grand Prairie will participate in the construction of any thoroughfare indicated on the Thoroughfare Plan when funds are available. In the event that the City requires oversizing of any thoroughfare, the City shall participate in such oversizing when funds are available.
- (7) If the City of Grand Prairie is unable to participate in the cost of any street installations due to the unavailability of funds for such purposes, then the developer shall be permitted to proceed with its contemplated development activities, including the installation of streets no wider than twenty-seven (27) feet.

(b) Water and Sewer Lines:

- (1) Water mains and sewer lines shall be installed by the developer as required by the City of Grand Prairie up to twelve inches (12") in size at the expense of the developer.
- (2) If mains larger than twelve inches (12") are required by the City, the difference in cost (including, but not limited to, the incremental increase in installation costs) between a twelve inch (12") main and the required size shall be paid by the City when funds are available.
- (3) At the request of the developer or others, the City shall pay its pro rata share of the cost (including, but not limited to, the incremental increase in installation costs) in the installation of all water mains required by the City to be extended into and through the property, when funds are available.

(c) The City may accept a dedication from the developer of its proportional share of the flood plain in lieu of any additional park and recreational land dedication or cash contribution.

(b) Nothing contained herein shall require the City to construct or contract to construct any project referred to herein if money is not available in the form of bond funds.

(c) Nothing contained herein shall be construed to require the City to appropriate money or submit to the vote of the electorate any bonds or to diminish or alter the discretion of the City Council in the issuance of bonds.

VIII.  
DEVELOPMENT PLAN

The development plan will be the finally approved plat for this tract as described in Section I, which under existing City Ordinances, may constitute a site plan for a planned development. No permits will be issued for construction unless in conformance with said development plan.

IX.

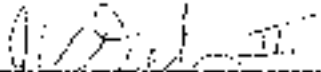
If any section, subsection, sentence, clause, phrase or portion of this ordinance is for any reason held invalid or unconstitutional by any court of competent jurisdiction, such shall be deemed a separate, distinct, and independent provision and such holding shall not affect the validity of the remaining portions thereof.

X.

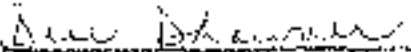
That nothing contained herein shall be construed as relieving the owner of the land described hereinabove of compliance with all other ordinances or charter of the City of Grand Prairie, Texas or laws of the State of Texas relating to the development of land or construction of buildings in said City, nor shall this ordinance be construed as relieving the owner of said land of compliance with all other provisions of Ordinance No. 2299 and its amendments, same being the Comprehensive Zoning Ordinance of said City, unless specifically modified by the passage of this ordinance.

That this ordinance shall be in full force and effect from and after its passage and approval.

PASSED AND APPROVED BY THE CITY COUNCIL OF THE CITY OF GRAND PRAIRIE, TEXAS, THIS THE 1st day of November, 1983 A.D.,

  
\_\_\_\_\_  
MAYOR, City of Grand Prairie, Tx.

ATTEST:

  
\_\_\_\_\_  
City Secretary

APPROVED AS TO FORM:

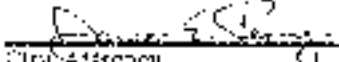
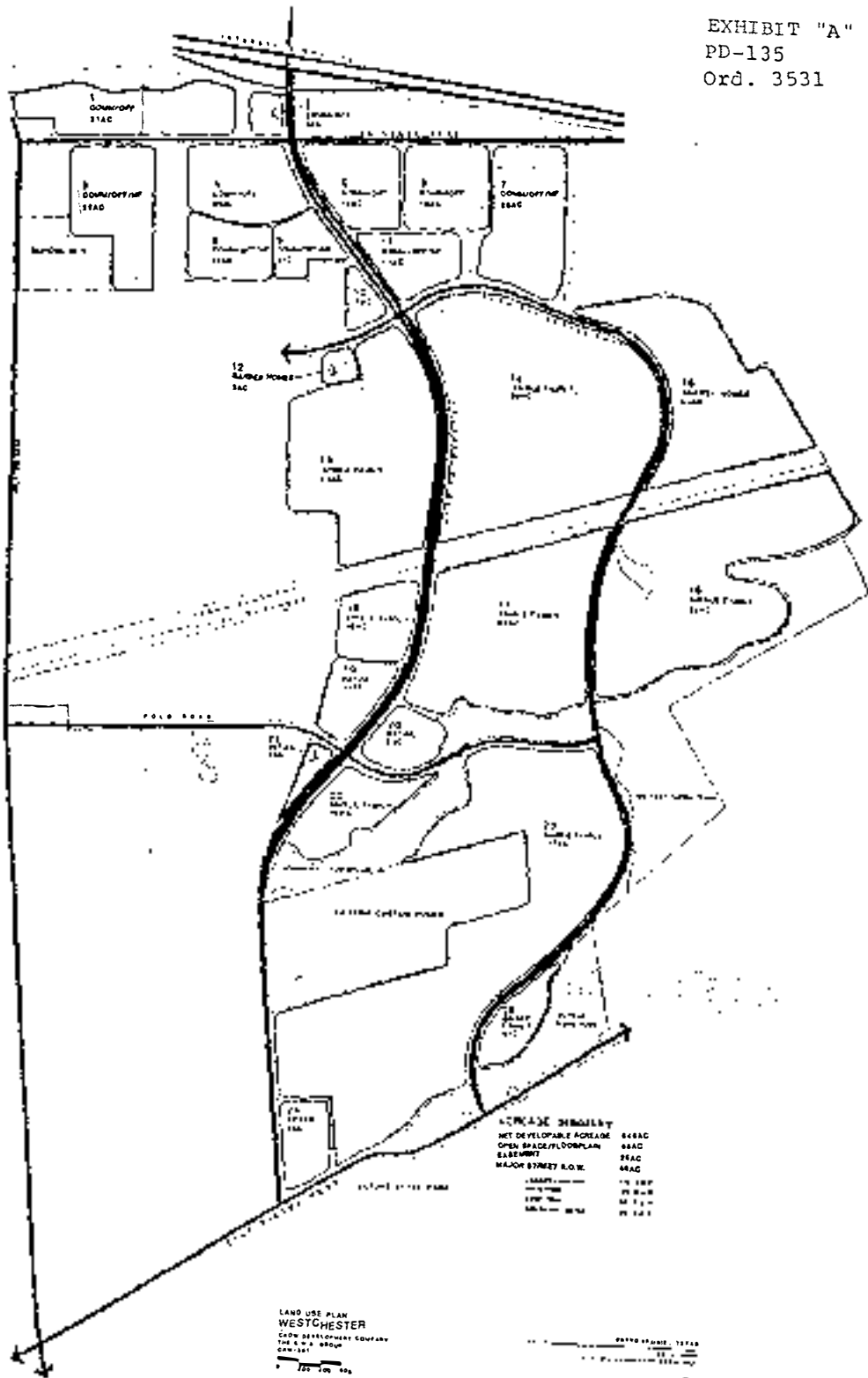
  
\_\_\_\_\_  
City Attorney



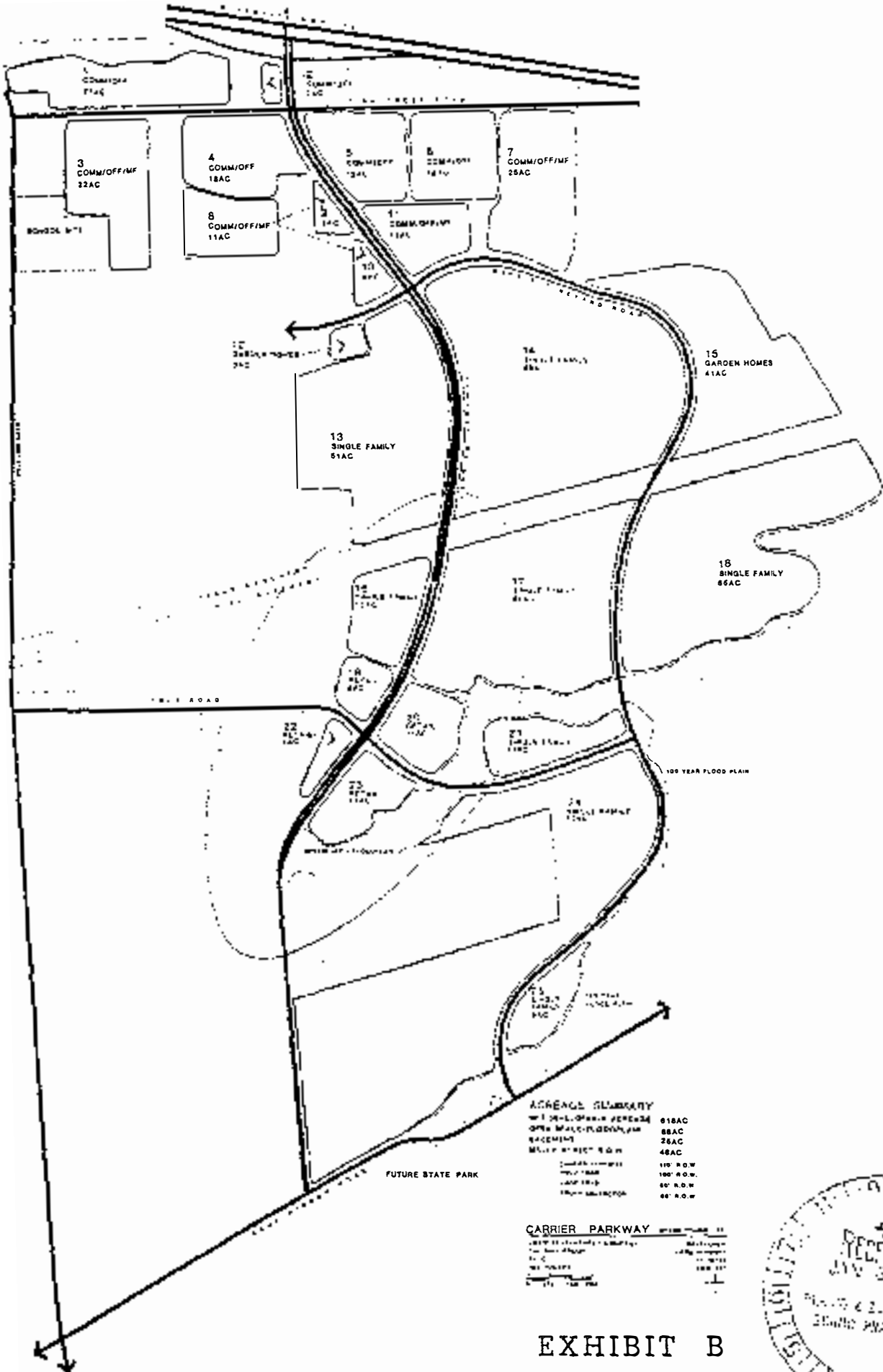




EXHIBIT "A"  
 PD-135  
 Ord. 3531







**ACREAGE SUMMARY**

NET DEVELOPABLE AREA	618AC
OPEN SPACE/FLOODPLAIN	88AC
ROADS	28AC
MINIMUM REQUIRED ROW	48AC
100' ROW	110' ROW
100' ROW	100' ROW
50' ROW	50' ROW
50' ROW	50' ROW

**CARRIER PARKWAY**

100' ROW

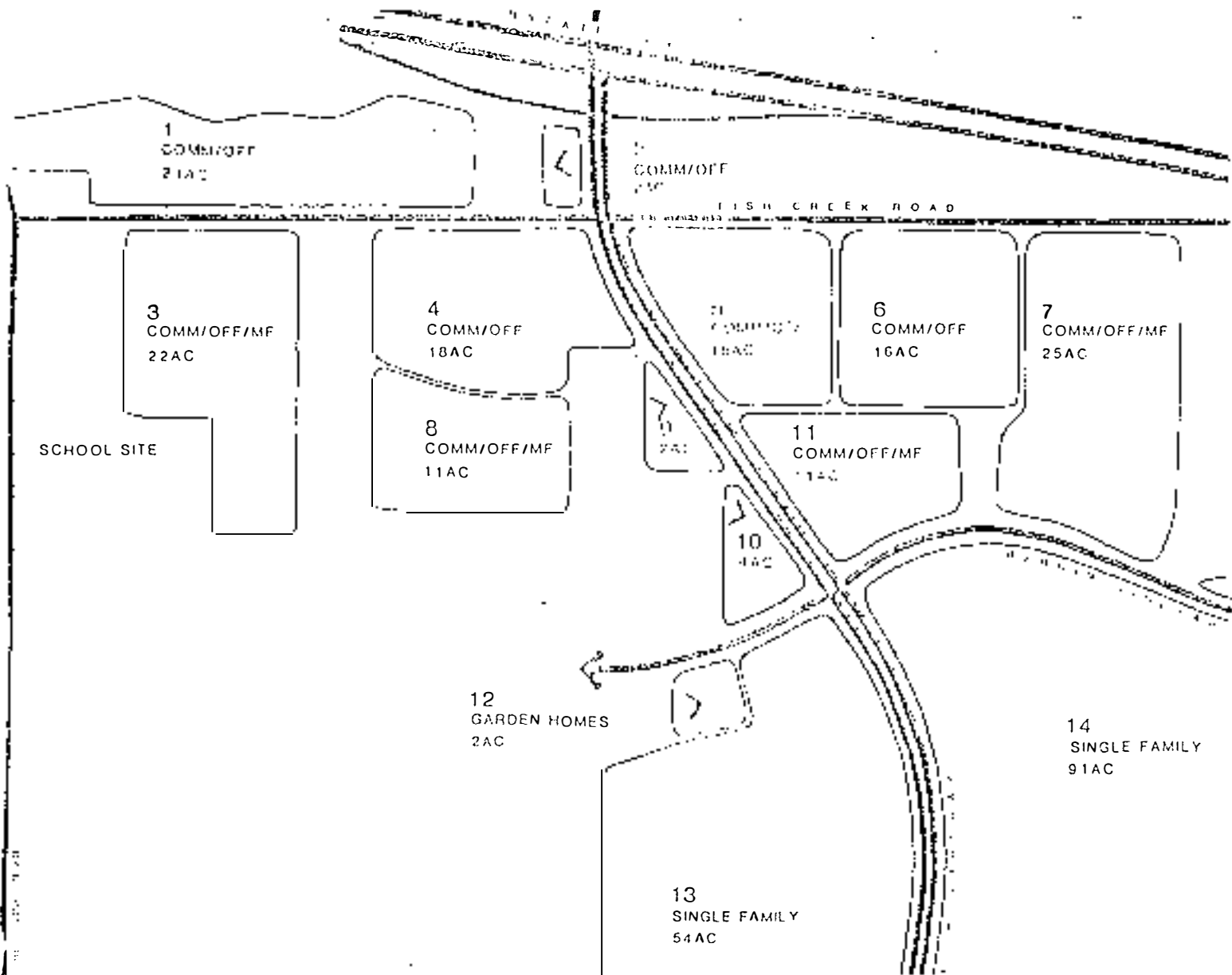
50' ROW

50' ROW

50' ROW

**EXHIBIT B**





1  
COMM/OFF  
21AC

2  
COMM/OFF  
2AC

3  
COMM/OFF/MF  
22AC

4  
COMM/OFF  
18AC

5  
COMM/OFF  
18AC

6  
COMM/OFF  
16AC

7  
COMM/OFF/MF  
25AC

SCHOOL SITE

8  
COMM/OFF/MF  
11AC

9  
COMM/OFF  
2AC

11  
COMM/OFF/MF  
11AC

10  
COMM/OFF  
4AC

12  
GARDEN HOMES  
2AC

14  
SINGLE FAMILY  
91AC

13  
SINGLE FAMILY  
54AC

FISH CREEK ROAD